

PC2306



Sunshine Flower House
PC 2306 Instruction Manual

NOTICE OF ASSEMBLE

Tips for assembling

1. Because this product contains small parts, children need to use this product with an adult to avoid accidental ingestion and cause suffocation hazard. There are sharp objects in the product, be careful not to pierce people to avoid injury.
2. After all the materials are used in the required amount in the operation steps, put the remaining materials back into the original bag until the installation is completed. (Avoid losing materials during the installation process)
3. The unit of dimension marked in the step diagram is "cm".
4. Tips for making template paper: Put the template on the back of the material, fix it with some small double-sided tape, and then cut out the material to prevent the cloth or template from moving in the cutting process, or causing errors in the cut material. Or lead to insufficient materials.
5. According to the "Parts Rule Example" at the bottom of this page, refer to the parts on the part number drawing, find the actual product and compare it with the bill of materials, and then install it after confirming that it is correct. (Wooden parts only)
6. It is not advisable to apply too much glue, so as not to wait for a longer time to dry, and overflow will affect the effect of the finished product.
7. There are unavoidable small deviations in the color of wood, fabric, and beads of different batches, without notice, thanks for understanding.

Tips for Assembling Wood



Find the corresponding block number, use a knife in the connection point gently press, you can take out the wood.

Use a knife to smooth out the burr.

Or use sandpaper to smooth out the burr

Testing on LED function

Be sure to test the LED lights before making the lighting, note that the LED white wire to the negative, gray wire to the positive reference to the following figure operation test.



1 DO NOT contact the LED wire end direct to the battery cell.



2 Use the provide battery holder. Make sure the correct polarity.

How to assemble the battery holder

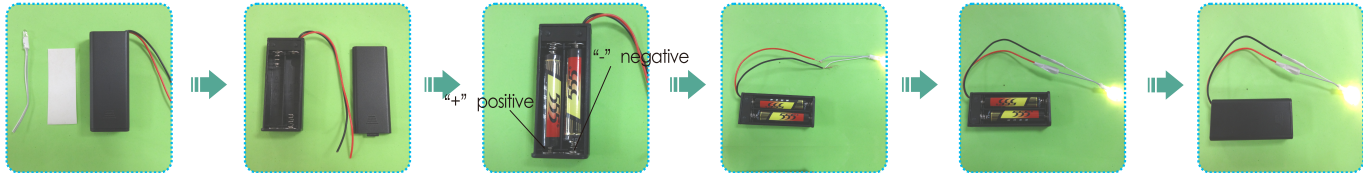

1. Material and tools needed:
- Battery holder, LED bulb, tape, screw driver and 2 pieces AAA size battery(not provided)

2. Use screw driver and take the lid off from the battery holder.

3. Insert the battery take notes on the polarity.

4. Connect the red wire to grey wire. Connect the black wire to white wire.

5. Wrap the exposed wire with the tapes.

6. Place the box lid and fastness with screw driver.

Examples of parts rule:

A01: The parts are directly in the box; B01: The parts are in the B bag; C01: The parts are in the C bag, and so on (Note: The printing paper is displayed in the step A07-1: The printing paper is placed directly in the box, The part number is A07-1. In the step, the template paper A09-F01 is displayed, A09 is the template paper, F01 is the cutting template used for the corresponding material, F01-1, F01-2 are the part numbers for the parts, and the printing paper and template paper are directly placed in the packaging box.)

Contents

Name	Materials Package	
Printing paper	A bag A07,A09(all printing paper are set in A07,all template paper are set in A09;total 4pieces of A4 paper)	
Flower rack 1	A bag +Cbag +E bag +Fbag +printing paper	page 3-4
Flower rack 2	A bag +Cbag +E bag +Fbag +printing paper	page 4-7
Flower rack 3	A bag +Cbag +E bag +Fbag +printing paper	page 8-9
Plant	A bag +E bag +Fbag	page 9
Table	Cbag +D bag +printing paper	page 10
Component	A bag +Dbag +Fbag +printing paper	page 10-11
Plants and Flowers 1	A bag +Bbag +E bag +Fbag +printing paper	page 12-13
Planter	A bag +Bbag +E bag +Fbag +printing paper	page 13
Plants and Flowers 2	A bag +E bag +Fbag +printing paper	page 14-15
Broom	Dbag +Fbag	page 15
Assembly The Frame	A bag +Bbag +Dbag +Fbag +printing paper	page 16-22
Installation Of Battery Box	G bag	page 22

Thumbnail of material list (reference only)

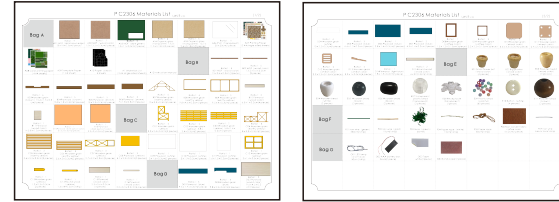

Thumbnail of printing paper & template paper (reference only)



Symbol description used

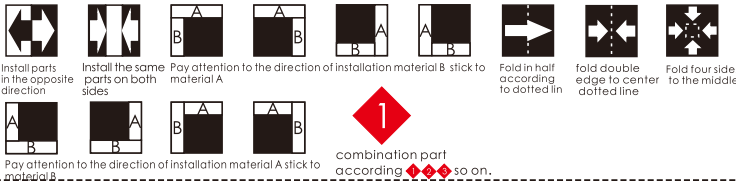

About the use of glue

Method for using glue:

1. After applying the glue, let it dry for a few seconds before pasting.
2. Fix it slightly with your hands, and finally put it aside to dry;

Tips:

1. When pasting the plane printing paper, a piece of waste bank card or telephone card can be used to wipe evenly after the glue is smeared on the wood board, and then the printing paper is pasted to squeeze out the air inside.
2. In the process of making glue, you need to wait for the glue to dry, the next component can be assembled at the same time.

Types of glue:

- White latex: Used for adhering soft materials, such as wood and paper.
- Alcoholic Glue: Used for adhering hard materials such as cloth, plastic, beads, wire, dust cover, etc.

Flower rack 1

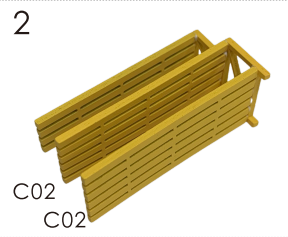
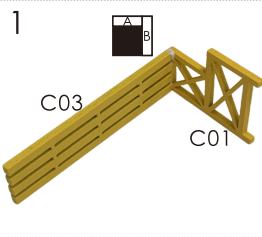
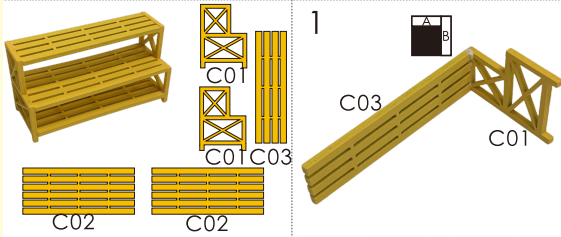

Please remove A08-36, A08-37, A08-39, A08-41, A08-44, and A08-32 for use before production

